

Installation Guide Front Upper Inners

Z 5164

Suits: Nissan R35

(Always refer to the current catalogue for complete application listings)

N.B: This installation guide should be used in conjunction with the workshop manual.

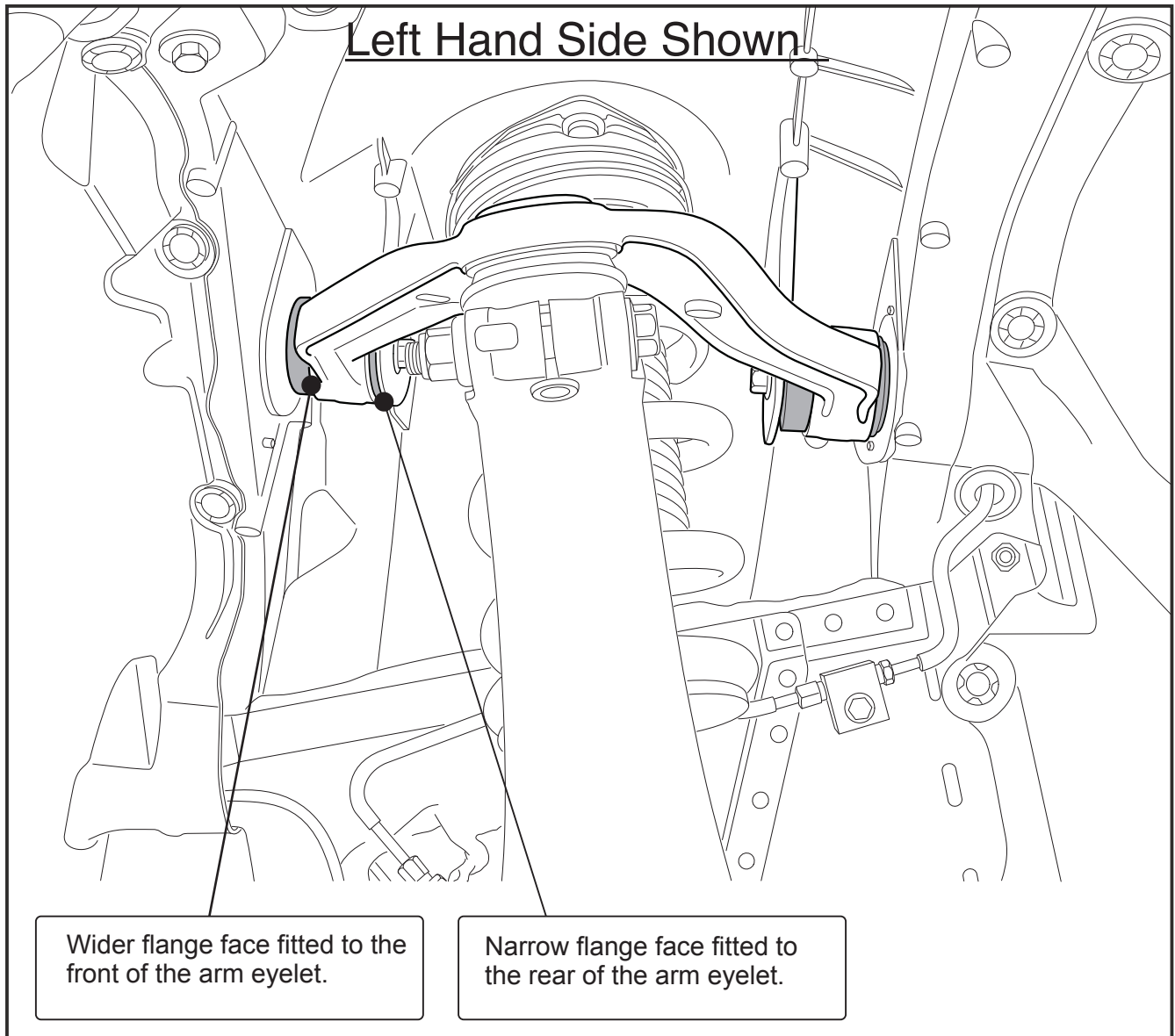

- Offset the eccentric tube inward to increase negative camber and outward to increase positive camber.
- Installing the bushes into the eyelet as per the image displayed will increase positive caster. Alternatively the bushes can be installed with the wider flange faces to the rear of the eyelet to increase negative caster.

N.B: It is recommended that a licenced workshop or trades person carry out the above procedure and that workshop manual and relevant safety procedures are followed in addition to the above.